

## Diaphragm seal

threaded process connection  
threaded design with PTFE lining

### Applications

- chemical industry
- petrochemical industry
- aggressive and high corrosive media

### Standards / Approvals

- ISO 228-1
- ASME B 1.20.1
- DIN 13-1



### Features

- threaded connection
- internal, PTFE copolymer diaphragm
- PTFE lining for other wetted parts
- threaded design
- wide range of instrument connections

### Pressure rating

- 16 bar - standard version
- 25 bar - special versions

### Process connection

- 1/2" BSPP, NPT
- M20x1,5
- other on request

### Instrument connection

- 1/2" BSPP, NPT
- 1/4" BSPP, NPT
- M20x1,5
- other on request

### Wetted parts material

- PTFE / PTFE copolymer

### Body material

- 304 (1.4301) stainless steel
- 316L (1.4404) stainless steel
- 316Ti (1.4571) stainless steel

### Filling fluid

- silicone oil (max. 200°C)
- high temperature oil (max. 315°C)
- oil for vacuum service
- vegetable oil
- fluorine oil
- other on request

### Optional capillary

- length up to 15m
- armored, axial entry
- 304 (1.4301) stainless steel

### Options

- radiator
- other on request

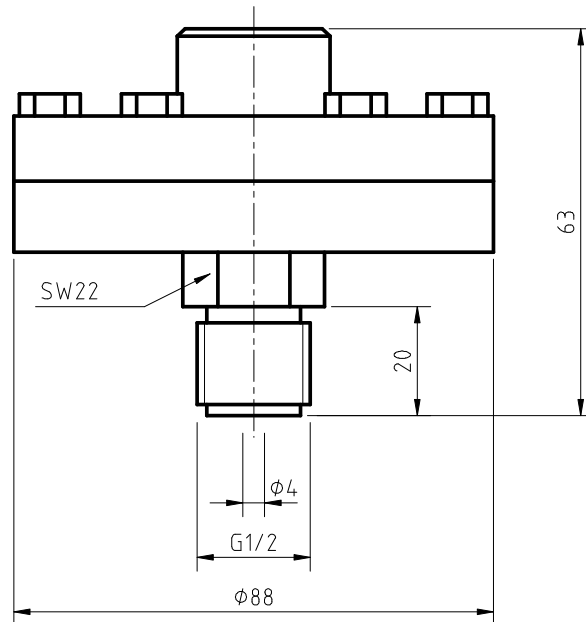

**Ordering:** model - process connection - material (body) - capillary length (if applicable) - instrument connection - other options or requests

For proper diaphragm seal manufacturing and calibration, process data - temperatures, pressures and media type - should be provided.